

## 1. PARTS IDENTIFICATION

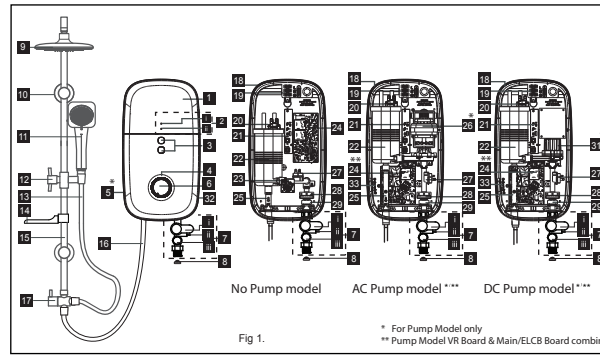

- |                                     |                                |
|-------------------------------------|--------------------------------|
| 1. Front Cover                      | 14. Soap Tray                  |
| 2. LED Indicators                   | 15. Slider Rail                |
| i) Earth LED Indicator              | 16. PVC Hose (1.0 meter)       |
| ii) Power/ELCB Indicator            | 17. Selector Valve             |
| 3. Test / Reset Button              | 18. Heater Base                |
| 4. Face Panel                       | 19. Terminal Block             |
| 5. Pump Button*                     | 20. Thermostat (Double-Action) |
| 6. Temperature Control Knob         | 21. PCB Board (Test & Reset)   |
| 7. 3 in 1 Stop Valve                | 22. Heater Tank                |
| i) Stop Valve Lever                 | 23. VR Board                   |
| ii) Flow Regulator Valve Adjustment | 24. Main/ELCB Board**          |
| iii) Built-in-Filter                | 25. Water Outlet Connection    |
| 8. Mesh Filter                      | 26. AC Pump*                   |
| 9. Rain Shower Head                 | 27. TRIAC                      |
| 10. Rail Bracket                    | 28. Reed Switch Assy           |
| 11. Handshower                      | 29. Water Inlet Connection     |
| 12. Adjustable Shower Holder        | 30. SMPS PCB Board             |
| 13. PVC Hose (1.5 meter)            | 31. D.C. Silent Pump*          |
|                                     | 32. Rating Label               |
|                                     | 33. Pump Board                 |



## 2. SAFETY INFORMATION

### WARNING !

2.1 Products manufactured by Electrolux are safe provided they are installed, used and maintained in good working order in accordance with our instructions and recommendations. Always refer to this manual if you have any doubt.

2.2 The appliance must be earthed. Improper grounding could cause electrical shock.

2.3 If any of the following conditions occur as shown below, immediately switch off the power supply and contact the Electrolux Consumer Care Center. Never attempt to repair the Instant Hot Shower yourself:

- If the Instant Hot Shower begins to make an odd noise, smell or smoke.
- If ELCB trips and Instant Hot Shower Indicator does not light up.
- Water temperature cannot be controlled.
- If the Instant Hot Shower shows signs of a distinct change in performance.
- If water leaks from inside.

2.4 If the Red (POWER) Indicator does not go off when you turn off the water, switch OFF the mains supply and contact Electrolux Consumer Care Centre for repair service. Special skill is required for repairing. NEVER try to repair the unit by yourself.

2.5 For Pump Model, it is highly recommended to connect the Water Inlet Connection to tank storage supply, otherwise it may cause damage to the Pump Motor.

2.6 When the Instant Hot Shower is used by someone such as child, elderly person, sick person and physically handicapped person, the person concerned is kindly requested to pay attention and check the shower temperature by hand from time to time. User is advised to test and adjust the water temperature before using.

2.7 During lightning/thunder, switch off the power supply to the Instant Hot Shower in advance to protect the Instant Hot Shower against possible damage.

2.8 The earth continuity conductor of the electrical installation must be effectively connected to all exposed metal parts of other appliances and services in the room, which in the Instant Hot Shower is to be installed to conform to local regulations and ensure proper earthing/grounding for ELCB to be effective.

2.9 **WARNING :** Metallic / chromed hose and conductive control valve shall not be used.

NOTE : When removing the Instant Hot Shower from package, a small amount of water may be found inside. This is normal as the Instant Hot Shower is tested during manufacturing process.

### CAUTION !

2.10 Installation must be carried out by a qualified personnel and in compliance local authority regulations.

2.11 This Instant Hot Shower must be permanently connected to the direct main line supply. A plug and socket is not recommended to be used.

2.12 For the correct size of wire conductor corresponding to different electrical loadings, please refer to Table 1.

2.13 This Instant Hot Shower operates at a minimum water flow rate of 2.0 litre/min and maximum working pressure of 6 bars. For direct connection from the water tank, the Instant Hot Shower must have an installation minimum 1.0m below the water tank.

2.14 The Instant Hot Shower will not function if there is insufficient water flow (min 2.0 litre/min) to trigger the flow switch.

2.15 The built-in ELCB will automatically cut off the power supply in case there is a current leakage over 15mA.

2.16 The thermostat will automatically cut off the power supply if it has sensed an abnormal rise in water temperature.

## 3. HEATER UNIT INSTALLATION

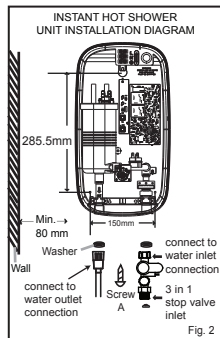

3.1 Select a suitable position in the bathroom.

3.2 Remove the screw (A) at the bottom of the Instant Hot Shower. (Fig. 2)

3.3 Remove the Front Cover from the bottom and then lift up the front cover.

3.4 Mark 3 Screw points of the Heater Base on the wall. The Instant Hot Shower position should be 1.5m above the bathroom floor.

3.5 Use 6mm diameter drill and make the wall plug holes in depth of 34mm.

3.6 Insert the wall plugs and mount the Instant Hot Shower firmly in position with the screws provided.

### RAIN SHOWER SET INSTALLATION PROCEDURES

#### RAIL BRACKET COVER & CAP DISMANTLE STEPS

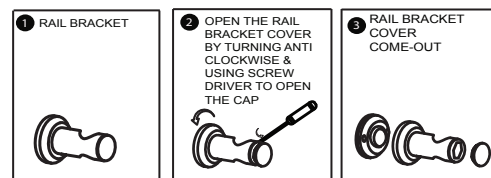
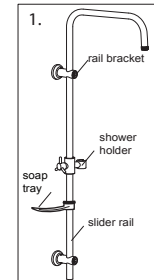

Fig.3

### RAIN SHOWER SET INSTALLATION PROCEDURES (CONT'D)

STEP 1  
Insert the Top Rail Bracket, Adjustable Shower Holder, Soap Tray & Bottom Rail Bracket to the Slider Rail.



STEP 3  
Select a suitable position for the Rain Shower Set then mark 4 screws point (2 on top and 2 on bottom). The gap of 2 screw hole was 38mm. It is recommended that the Top Rail Bracket position at height of 1950mm to the floor and Bottom Rail Bracket 1300mm to the floor.

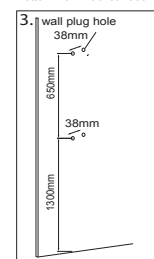

STEP 2  
Connect the Selector Valve to the bottom of Slider Rail.

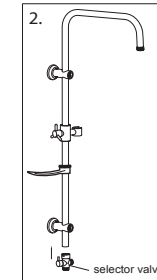

STEP 4  
Use 6mm diameter drill and make the wall plug holes in depth of 34mm. Insert the wall plugs and mounting terminal firmly in position with the screw provided.

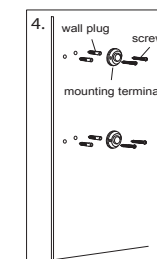

### RAIN SHOWER SET INSTALLATION PROCEDURES (CONT'D)

STEP 5  
Mount the Slider Rail (connected with Rail Bracket, Adjustable Shower Holder and Selector Valve) to the mounting terminal by turns the terminal cover.

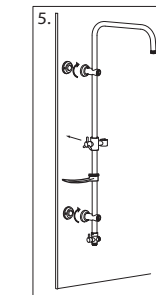

STEP 7  
Connect the Rain Shower Head to the top of Slider Rail, 1.5Meter PVC Hose to Hand Shower Head and 1Meter PVC Hose to the Heater. Connected be sure to put in the Rubber Washer.

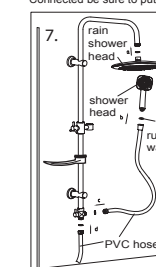

STEP 6  
Remove the cover and cap from the Rail Bracket (Fig. 3A) and screw the rail bracket by turning the cover clockwise. Using hexagon tool to tighten the plastic nut to the desired position and then replace the cover.

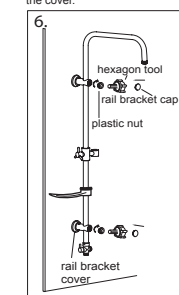

STEP 8  
Recommended Height for Rain Shower Set.

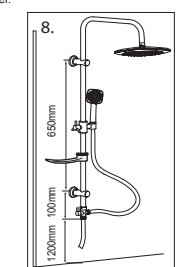

## 4. PLUMBING PROCEDURE

### CAUTION!

This Instant Hot Shower is a single point system and the "Water Outlet" can only be fitted to the Hose and Handshower set provided. **MUST NOT TO CONNECT CONTROL VALVE OR FITTING CAN BE FITTED TO THE WATER OUTLET.**

4.1 Connect the 3 in 1 Stop Valve to the Water Inlet with washer. Use correct tools to tighten and be careful not to over tighten and damage the plastic nut.

4.2 Connect the incoming water piping to the 3 in 1 Stop Valve (1/2" BSP).

**Make sure to put the Mesh Filter between 3 in 1 Stop Valve and incoming water piping.**

4.3 If in any case, the 3 in 1 Stop Valve is not use or omitted, **make sure to put the Mesh Filter between the Instant Hot Shower inlet pipe and incoming water pipe.**

4.4 Turn on the water mains to drain out all plumbing dirt before connecting the water supply to the Instant Hot Shower, the water supply to the Instant Hot Shower must be free from mud and dirt. Always KEEP the water supply to the Instant Hot Shower free from mud and dirt at all time during usage.

### IMPORTANT

**THE HEATER TANK MUST BE FILLED UP WITH WATER BEFORE TURNING ON THE POWER SUPPLY TO PREVENT ANY DRY BURNT DAMAGE TO THE HEATING ELEMENT.**

4.5 Connect the Hose and Handshower to the outlet of Instant Hot Shower, be sure to put in the Washer in between the connection. (Fig. 2)

4.6 Hook the Handshower to the Slider Rail Shower Holder and adjust to your ideal position.

4.7 Check if any water leakage.

4.8 Do not use white tape during piping installation.

### WARNING!

4.9 **THE WATER INLET AND OUTLET MUST BE INSTALLED CORRECTLY, OTHERWISE INSTANT HOT SHOWER WILL NOT FUNCTION.**

4.10 **DO NOT APPLY PLUMBING CEMENT ON CONNECTION. WHENEVER NECESSARY, USE ONLY THREAD OR SEALING TAPE.**

## 8. HANDSHOWER SPRAY

This Innovative adjustable Handshower has 5 different spray patterns (STANDARD, JUMBO, SOOTHE, MIX and MASSAGE). The patterns are described as following:

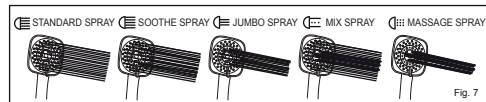

Clean the Handshower Head holes by using the soft brush from time to time.

(Recommended once a week)

Note: Take care not to damage the holes of the Handshower Head during cleaning.

## 9. MAINTENANCE

Read the section 'SAFETY INFORMATION' first.

### 9.1 TEST THE 'ELCB' REGULARLY

(This procedure is highly recommended test at least once a month)

Turn on the power supply and water supply, both Red (HEATER) and Green (ELCB) Indicators will light up if the Temperature Control Knob is in 'ON' position. Press the ELCB Test Button, both HEATER and ELCB Indicators should go off. Press the Reset Button to resume the power supply.

### 9.2 CLEAN THE FILTER REGULARLY

Clean the Mesh Filter regularly to prevent blockage (Fig. 8). Remove the Built-in Filter by turning its cap anticlockwise. Whenever need flush the internal strainer with water to remove any trapped sediments. Whenever fixing back the Built-In Filter, beware of the alignment of Internal Strainer. Use the protruded guideline within Stop Valve to position the Internal Strainer.

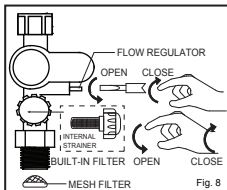

Fig. 8

### WARNING!

9.3 If the HEATER Indicator does not go off when you press the ELCB Test Button, switch OFF the mains supply and contact Electrolux Consumer Care Centre for repair service. Special skill is required for repairing. NEVER try to repair the unit by yourself.

### 9.4 CLEANING PRECAUTION!

Do not use thinner, alcohol, petrol or any other organic solutions to clean the set. Use only damp cloth with mild detergent.

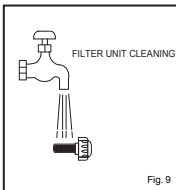
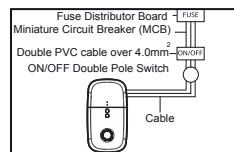

Fig. 9

## 5. ELECTRICAL INSTALLATION

### WARNING!

5.1 This appliance must be earthed. Improper grounding could cause electrical shock.  
5.2 Remember to SWITCH OFF the power supply before carrying out any electrical work.  
5.3 Refer to TABLE 1 for the correct cable size.  
5.4 Use double insulation cable of over 4.0mm<sup>2</sup>  
5.5 Lead the power cable from MCB to a "ON/OFF" double pole Linked Switch having a contact separation of at least 3mm in all poles outside the bathroom, then lead a cable to the terminal block inside the Instant Hot Shower. (Fig. 4)



NOTE: Refer to TABLE 1 for electrical loading and correct size of wire conductor

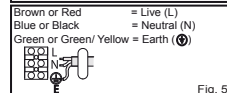

### PROCEDURE :

5.6 Insert the wall embedded cable through Side Entry 'A' by cutting a hole at the source cord rubber holder and lead the cable to Cable Bracket 'B'. (Fig. 6)  
5.7 Connect the cable as following:  
BROWN or RED → LIVE (L)  
BLUE or BLACK → NEUTRAL (N)  
GREEN or GREEN/YELLOW → EARTH (E)  
5.8 Clamp the cable to the correct position. CHECK IF THE WIRING CONNECTION IS CORRECT and replace the cover.  
5.9 When putting back the Front Cover, please take note of the procedure shown below :  
-Ensure the position is correct, turn the Temperature Control Knob Insert to OFF position as shown in Fig.A (At the Heater Base)  
-Install the Front Cover, turn the Temperature Control Knob to OFF position to align with the VR shaft as shown in Fig.B (At the Front Cover)  
5.10 Fix the Temperature Control Knob and screw 'A' (Fig. 2).

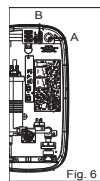

Fig. 6

### METHOD OF ALIGNMENT WHEN REPLACING FRONT COVER

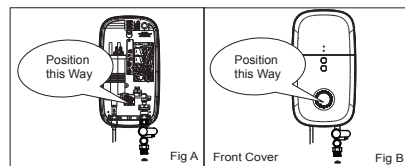

Fig A

Front Cover

Fig B

## 10. WIRING DIAGRAM

### WIRING DIAGRAM -WITH ELCB, AC PUMP DPDT MODEL

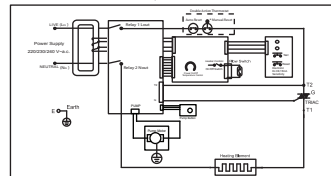

### WIRING DIAGRAM -WITH ELCB, NO PUMP DPDT MODEL

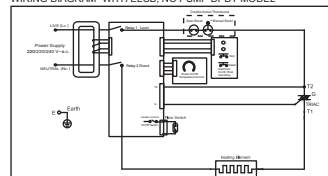

### WIRING DIAGRAM -WITH ELCB, DC PUMP DPDT MODEL

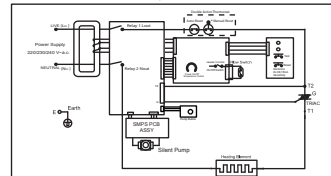

### \* Thermostat Manual Reset (90°C Thermostat)

For Models rated 4.8kW and below, thermostat is manually resettable. For models rated 6.0kW and above, thermostat needed to be replaced once permanently tripped.

## 11. ELECTRICAL SPECIFICATION

TYPE	ELECTRONIC POWER CONTROL
ELECTRICAL LOADING	3.6kW 240V a.c. 50/60Hz
Min. WATER FLOW RATE	2 Litre / min
Min. INLET WATER PRESSURE	0.1 Bar (10 kPa ; 1.45 psi)
Max. INLET WATER PRESSURE	6.0 Bar (0.6 MPa ; 87.02 psi)
WATER CONNECTION	1/2" BSP SINGLE POINT SYSTEM
DIMENSIONS	220 (W) X 401 (H) X 90 (T) mm
NET WEIGHT	2.5 kg - ELCB , DPDT , AC PUMP 2.0 kg - ELCB , DPDT , DC PUMP 1.5 kg - ELCB , DPDT , NO PUMP

Note : The specification, actual product's cosmetic design and accessories parts shown are correct at the time of printing and may be subjected to change without prior notice.

## 6. TABLE 1 - CABLE SIZE TABLE

Voltage (AC)	Power (kW)	Current (A)	Conductor Size (csa)		On/Off Switch (A)	Fuse / MCB (A)
			mm <sup>2</sup>	Conduit Cable		
240V ~ 50/60 Hz (Malaysia Model)	3.6	15.0	4.0	7 / 0.85mm	56 / 0.30 mm	20

## 7. TEST RUN

7.1 Turn on the water supply and 3 in 1 Stop Valve, the water will flow through the Handshower.

7.2 Switch on the power supply. The 2 LED Indicator light shall turn ON/OFF 3 times in sequences to indicate the set are self checking.

If the Instant Hot Shower is not earthed properly, the Earth Led indicator light will OFF, during usage or standby, Earth Led indicator light also OFF if Live & Neutral reverse connection.

7.3 Turn the Temperature Control Knob to 'ON', the Red indicator light (HEATER POWER) will turn on, (ELCB/Power Led indication are combine Led indicator light- ELCB is GREEN & Power is RED) hot water will flow out within a few seconds. The more Temperature Control Knob being turned in clockwise direction, the hotter is the water.

7.4 The Instant Hot Shower might not be hot enough even at the 'MAX' position if incoming water supply from the mains is too cold or the pressure of water is too high. In this case, you may adjust the 3 in 1 Stop Valve to reduce the water inflow in order to get the desired showering temperature. (Recommended flow rate of below 6litre/min)

7.5 Check the Built-in ELCB as following:

- Press the "TEST" Button, the Built-in ELCB should trip and cut off the power supply. ELCB and Power Indicators should light off. -Press the "RESET" Button, the 2 LED Indicator light shall turn ON/OFF 3 times in sequences to indicate self checking as in 7.2 above and the Instant Hot Shower should resume normal function, the Green LED Indicator should light on. If procedures stated above prevailed, the ELCB is functioning in normal condition.

7.6 The height and direction of Shower Holder are adjustable by releasing the shower holder knob clockwise and anticlockwise.

7.7 Move the Handshower to the desired angle. A ratchet mechanism in the Shower Holder will hold the Handshower in selected position.

7.8 It is unnecessary to turn the Temperature Control Knob to "OFF" position when the Instant Hot Shower is not in use.

7.9 Switch OFF the power supply after shower.

7.10 For Pump Model: The pump will auto ON when power ON and 3 in 1 stop valve open (and there is water supply)

7.11 **Booster Pump Function:** After incoming power supply is ON, and water supply flow through 3 in 1 stop valve while open position but the water flow rate is not sufficient to activate the flow sensor. Booster Pump Function can be useful to help to increase the incoming water flow rate. Press the pump button to activate the booster pump function. The booster pump function will be ON to increase the incoming water flow rate. While the Booster Pump Function is working and the incoming water flow rate can be maintained above flow sensor activation level, the Electric Water Heater will be resumed working continuously as normally. If the incoming flow rate can not be maintained above flow sensor activation level, the Booster Pump Function will be auto OFF and the Electric Water Heater will not be able to function normally due to incoming flow rate is too low. (Advisable to avoid applying Booster Pump Function to increase the incoming water flow rate more than 3 times of each showering).

## WE'RE THINKING OF YOU

Thank you for purchasing an Electrolux appliance. You've chosen a product that brings with it decades of professional experience and innovation. In ingenious and stylish, it has been designed with you in mind. So whenever you use it, you can be safe in knowledge that you'll get great results every time. Welcome to Electrolux.

### Visit our website to:

Get usage advice, brochures, trouble shooter, service information:  
[www.electrolux.com](http://www.electrolux.com)

Register your product for better service:  
[www.registerelectrolux.com](http://www.registerelectrolux.com)

Buy Accessories, Consumables and Original spare parts for your appliance:  
[www.electrolux.com/shop](http://www.electrolux.com/shop)

## CONSUMER CARE AND SERVICE

We recommend the use of original spare parts.

When contacting Service, ensure that you have the following data available. The information can be found on the rating plate. Model, PNC, Serial Number. (Right side of unit).

Warning/ Caution-Safety information.

General information and tips.

Environmental information.

Subject to change without notice.

## CONSUMER CARE

### Indonesia

Hotline service: 0804119999

PT. Electrolux Indonesia

Electrolux Building

Jl.Abdul Muis No.34, Petjojo Selatan,

Gambir Jakarta Pusat 10160

Email: [customercare@electrolux.co.id](mailto:customercare@electrolux.co.id)

SMS & WA : +62-812-8888-8883

Malaysia

Consumer Care Center Tel: 1300-88-11-22

Electrolux Home Appliances Sdn. Bhd.

Corporate Office Address: Unit T2-7, 7th Floor, Tower 2,

Jaya3 HyperOffice, No. 3, Jalan Senawang, Seksyen 13,

46100 Petaling Jaya, Selangor

Office Tel : (+60 3) 7843 8999

Office Fax : (+60 3) 7955 5511

Consumer Care Center Address: Lot C6, No. 28,

Jalan 19/22, Taman Perindustrian Tiorng Nam,

40200 Shah Alam, Selangor

Consumer Care Center Fax : (+60 3) 8524 2521

Email : [malaysia.customercare@electrolux.com](mailto:malaysia.customercare@electrolux.com)

Thailand

Consumer Care Tel : (+66 2) 725 9000

Electrolux Thailand Co., Ltd.

Electrolux Building 14th Floor

1910 New Phetchaburi Road,

Bangkok, Hual Khwang, Bangkok 10310

Office Tel : (+66 2) 7259 0000

Office Fax : (+66 2) 7259 2939

Email : [customercarethai@electrolux.com](mailto:customercarethai@electrolux.com)

### Philippines

Consumer Care Center Toll Free : 1-800-18-845-CARE 2273

Consumer Care Hotline : +63 2 845-CARE 2273

Electrolux Philippines, Inc.

10th Floor, West Avenue Building

5th Avenue Corner 32nd Street

Bonifacio Global City,

Taguig Philippines 1634

Trunkline : +63 2 737-4756

Website : [www.electrolux.com.ph](http://www.electrolux.com.ph)

Email : [viccar@electrolux.com](mailto:viccar@electrolux.com)

### Singapore

Consumer Care Center Tel: (+65) 6727 3699

Electrolux S.E.A. Pte Ltd.

1 Fusionopolis Place,

#07-10 Galaxia, West Lobby

Singapore 138522

Office Fax : (+64 8) 3910 5470

Email : [viccar@electrolux.com](mailto:viccar@electrolux.com)

### Vietnam

Consumer Care Center Toll Free : 1800-58-88-99

Electrolux Vietnam Ltd.

Floor 9th, A83 Tower

76 Le Lai Street - Ben Thanh Ward - District 1

Ho Chi Minh City - Vietnam

Office Tel : (+84 8) 3910 5465

Office Fax : (+84 8) 3910 5470

Email : [viccar@electrolux.com](mailto:viccar@electrolux.com)

### Hongkong

Tel: (+852) 8203 0298

Dah Chong Hong, Ltd. - Service Centre

8/F., Yee Lin Godown Block C

2-28 Kwai Lok Street, Kwai Chung, N.T.